

# Architectural Slimline Overhead Door Closer

ICK1955 Size 2-5

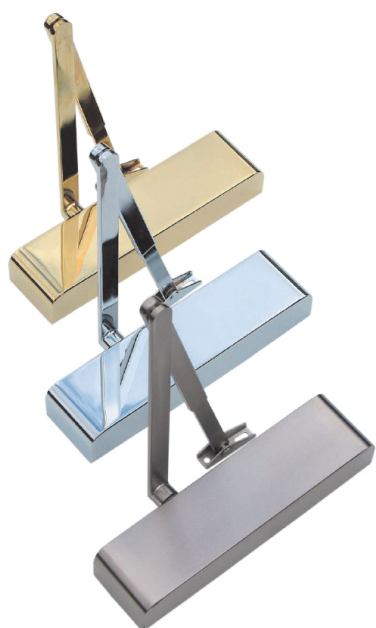

## Product Overview:

A highly efficient, durable and stylish variable power overhead door closer. Suitable for most applications particularly those with public use.

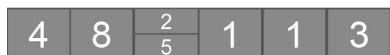

## Testing & Standards:

- CE marked against EN 1154
- Included in successful fire test to EN 1634
- Certifire approved - refer to CF689 for scope of approval
- Safe in use
- High corrosion resistance

## BS8300/Equalities Act Approved Document 'M'

The ICK1955 Overhead door closer (Standard fixing position) has an opening force (0-30°) less than 30N when fitted to a minimum width door of 900mm (Fig 1) & 826mm (Fig 6), and has an opening force (30-60°) less than 22.5N when fitted to a minimum width door of 826mm.

Therefore the suitable width of door for the ICK1955 Overhead door closer when fitted in the above fixing positions shall be 900mm, Fig 1 & 826mm Fig 6.

NOTE : BS 8300 Requirements are for the whole door set and therefore the minimum suitable door width will increase when the door closer is fitted with all other items of ironmongery on site.

## Specification

Closing force (Fig 1 & Fig 6)	EN Size	2-5
Door Size (max)	Width (mm)	1250
	Weight (kg)	100
Body Dimensions	Length (mm)	236
	Width (mm)	55
	Depth (mm)	38
Application	Regular Fig. 1	Yes
	Parallel Arm Fig. 6	Yes
	Transom Fig. 61	Yes*
Mechanism	Rack & Pinion	Yes
Power Shoe Bracket		Yes
Angle of Opening		180°
Non Handed		Yes
Power Adjustment by Spring		Yes
Power Adjustment by Position		No
Adjustable Sweep Speed		Yes
Adjustable Latch Speed		Yes
Adjustable Backcheck		Yes
Adjustable Delayed Action		Yes*
Guarantee		25 years

## Options

Architrave Brackets	Yes*
Drop Plates	Yes*
Hold-Open Arm (not suitable for use on fire doors)	Yes*
Slide Arm & Track	Yes*
Hollow Door Fixing Pack	Yes*
Saddle Bracket for Glass Door Installation	Yes*

## Cover Options

Radius Edge	Yes
Semi-Radius	Yes
Full Radius	Yes
Square	Yes

## Finish Options

No Cover	SIL
Cover	SSS, PSS, PB, RAL, T304, BRONZE

\* these options are not covered by the Certifire approval

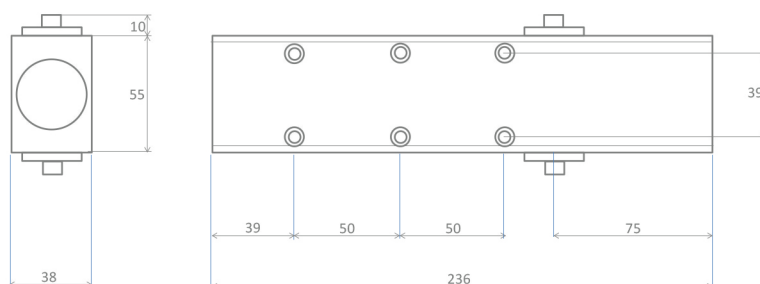

## Doorfit Products Ltd.

Icknield House, Heaton Street, Birmingham B18 5BA

Call us 0121 523 4171

Email us [info@doorfit.co.uk](mailto:info@doorfit.co.uk) Visit us [www.doorfit.co.uk](http://www.doorfit.co.uk)