

PULL SIDE - REGULAR APPLICATION (FIG. 1)

ANGLE OF OPENING 180° SUBJECT TO HINGE & SURROUNDING STRUCTURE

R.H. DOOR

L.H. DOOR

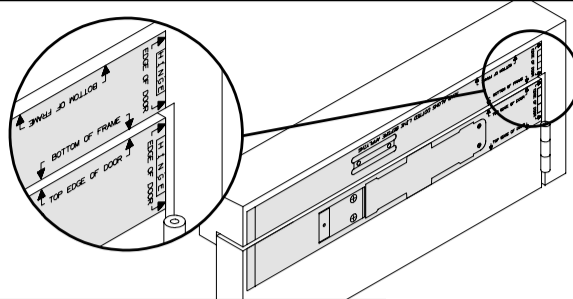
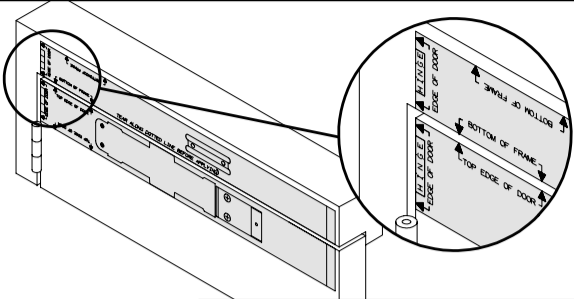

1 PEEL TEMPLATES OFF BACKING PAPER
 POSITION ON DOOR/FRAME PILOT DRILL 6 HOLES **1**

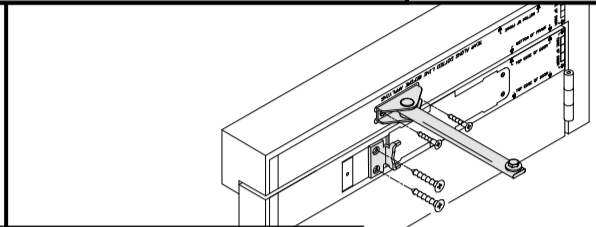
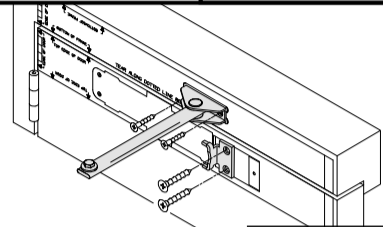

2 FIT MECHANISM BRACKET (2 SCREWS)
 FIT ARM BRACKET ASSEMBLY (2 SCREWS) **2**

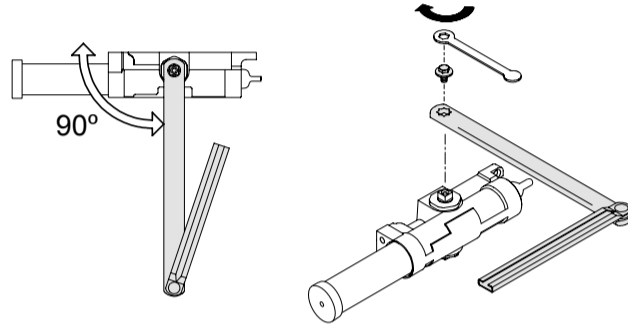
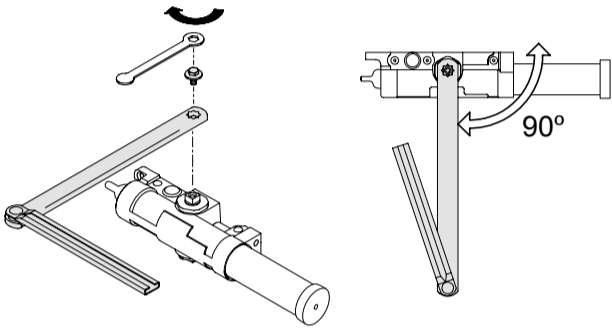

3 FIT MAIN ARM ASSEMBLY TO MECHANISM (90°)
 SECURELY TIGHTEN FIXING SCREW WITH SPANNER **3**

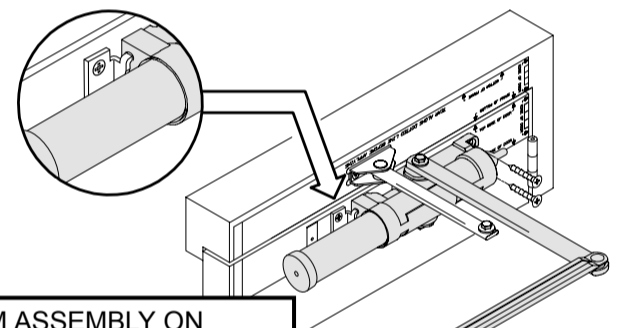
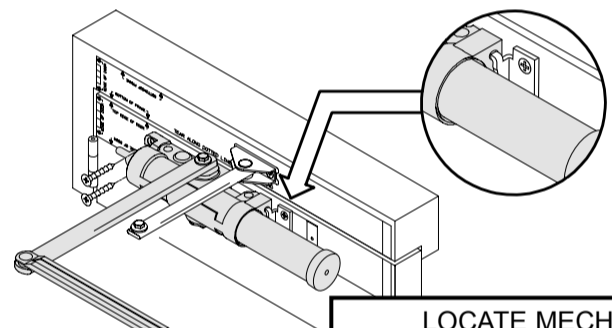

4 LOCATE MECHANISM ASSEMBLY ON
 BRACKET AND SECURE (2 SCREWS)
PEEL OFF TEMPLATES **4**

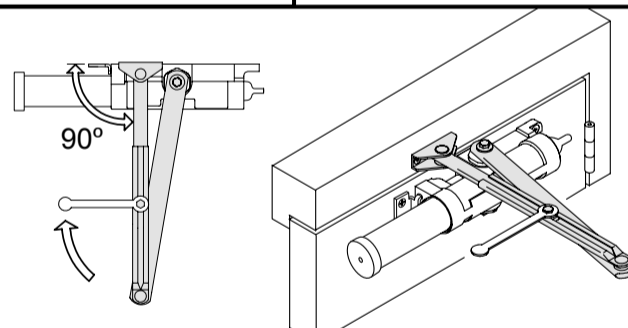
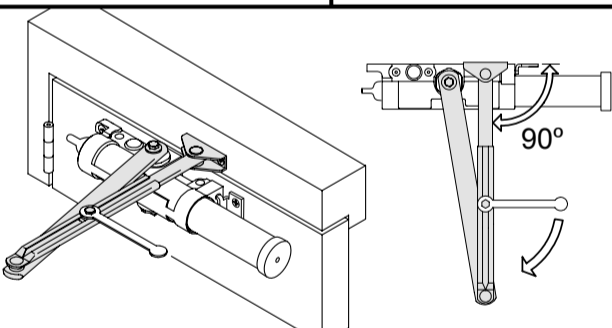

5 OPEN DOOR TO ENGAGE SECONDARY ARM STRIP AND TUBE
 CLOSE DOOR AND SET SECONDARY ARM AT 90° TO DOOR FACE
 SECURELY TIGHTEN CLAMP BOLT WITH SPANNER **5**

BACKCHECK CLOSER

BACKCHECK & DELAYED ACTION CLOSER

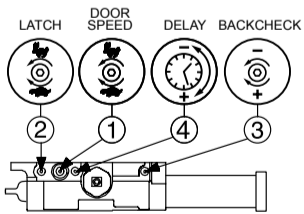
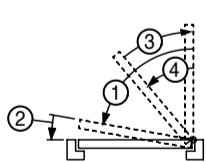
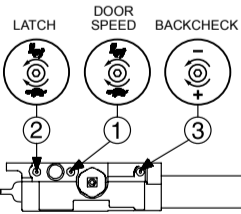

POWER (FIG.1)

FACTORY SET TO SIZE 4	
CLOSER POWER SIZE	NUMBER OF TURNS (APPROX)
2	-6
3	-3
4	0
5	+6
6	+12

6 IF NECESSARY ADJUST POWER AND DOOR SPEEDS **6**

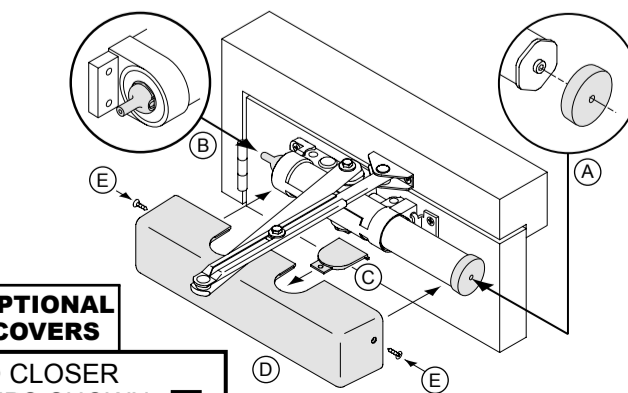
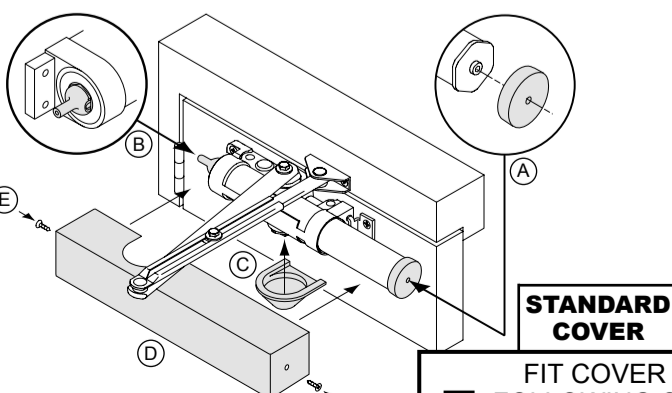

7 FIT COVER TO CLOSER
 FOLLOWING STEPS SHOWN
 (2 SCREWS) **7**

CLOSER POWER
 DOOR SIZE

#1
 20kg
 750 MAX

#2
 40kg
 850 MAX

#3
 60kg
 950 MAX

#4
 80kg
 1100 MAX

#5
 100kg
 1250 MAX

#6
 120kg
 1400 MAX

MAINTENANCE (Quarterly)
 Check that the door closer closes the door correctly and fixing screws are tight. Periodically apply light oil to arm knuckle joints and door hinges.

FOR TRANSOM AND PARALLEL ARM INSTALLATION PROCEDURE SEE OVERLEAF

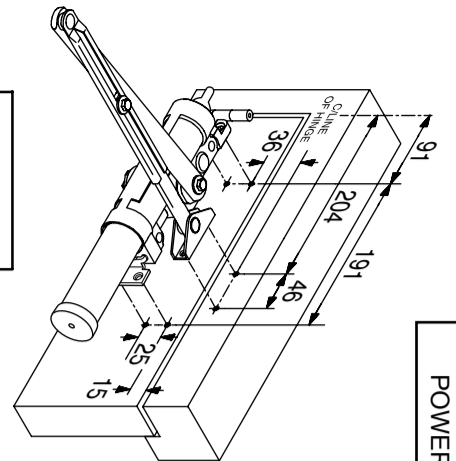
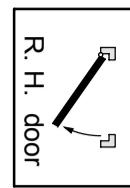

REGULAR FIXING (FIG.1)
 POWER SIZE 2 - 6

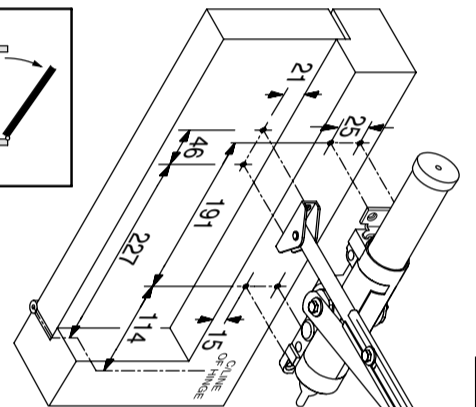
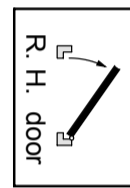
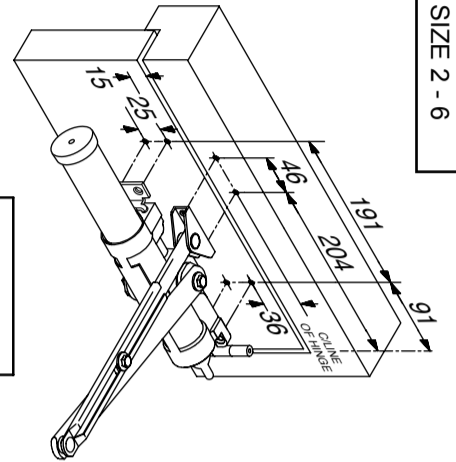
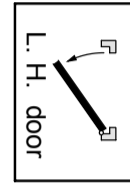

TRANSOM FIXING (FIG.61)
 POWER SIZE 2 - 6

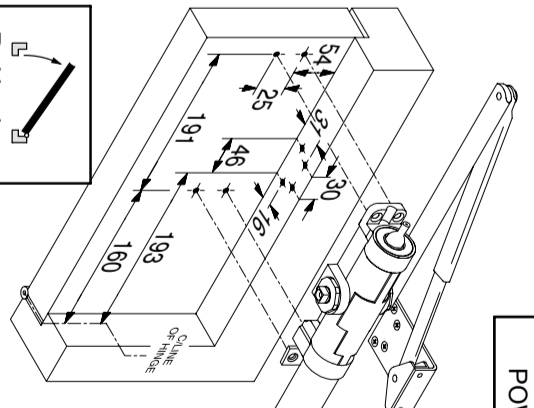
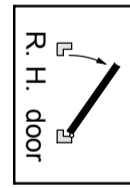
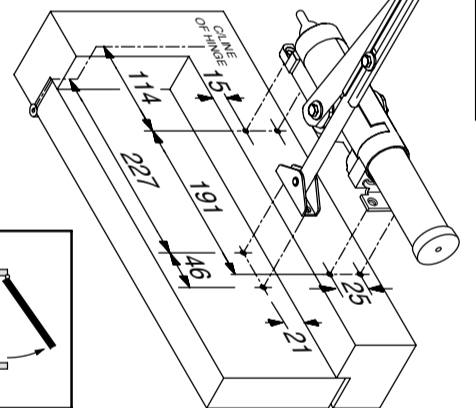
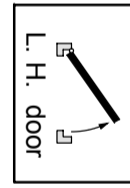

PARALLEL ARM FIXING (FIG.66)
 POWER SIZE 1 - 5

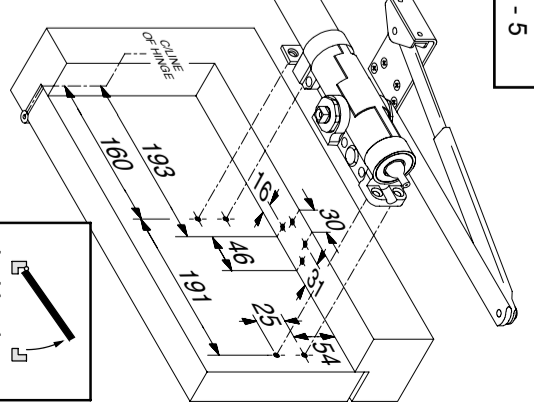
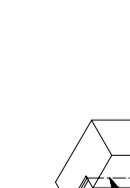

NOTE - all dimensions are in millimetres

PUSH SIDE - PARALLEL ARM APPLICATION (FIG.66)

ANGLE OF OPENING 180° SUBJECT TO HINGE & SURROUNDING STRUCTURE

L.H. DOOR

R.H. DOOR

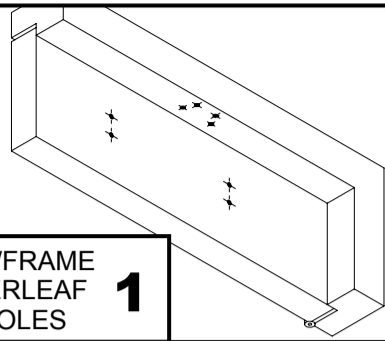
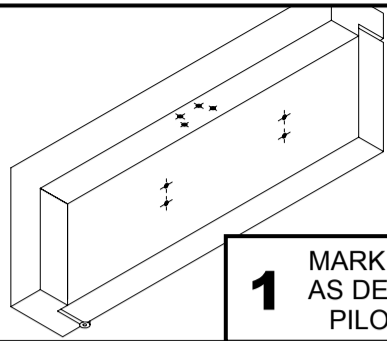

1 MARK OUT DOOR/FRAME AS DETAILED OVERLEAF PILOT DRILL 8 HOLES **1**

1 MARK OUT DOOR/FRAME AS DETAILED OVERLEAF PILOT DRILL 6 HOLES **1**

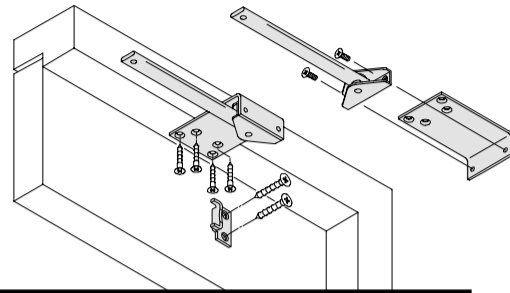
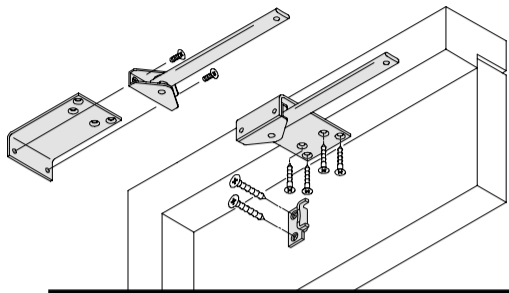

2 FIT MECHANISM BRACKET (2 SCREWS) FIT ARM BRACKET ASSEMBLY TO FIG.66 BRACKET (2 SCREWS) FIT BRACKET ASSEMBLY TO FRAME (4 SCREWS) **2**

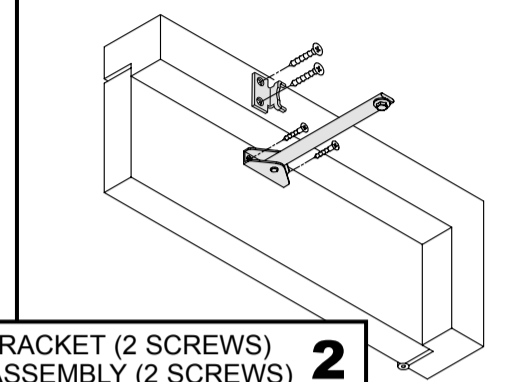
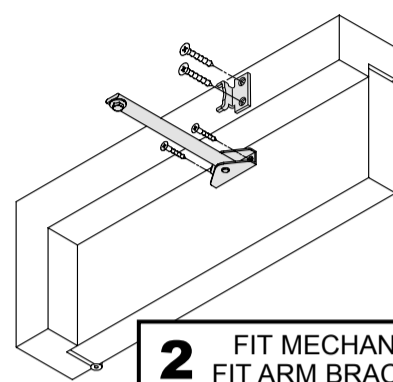

2 FIT MECHANISM BRACKET (2 SCREWS) FIT ARM BRACKET ASSEMBLY (2 SCREWS) **2**

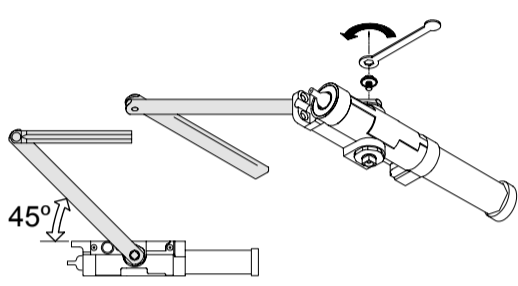
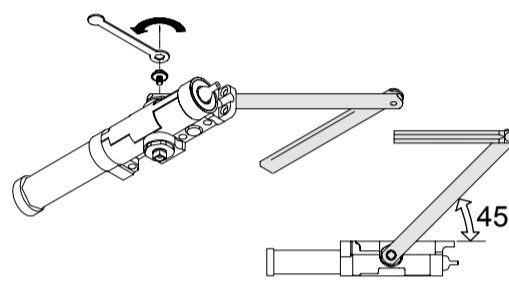

3 FIT MAIN ARM ASSEMBLY TO MECHANISM (45°) SECURELY TIGHTEN FIXING SCREW WITH SPANNER **3**

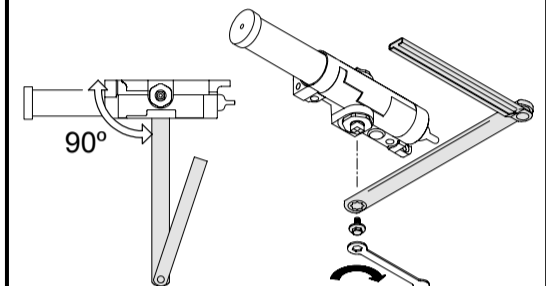
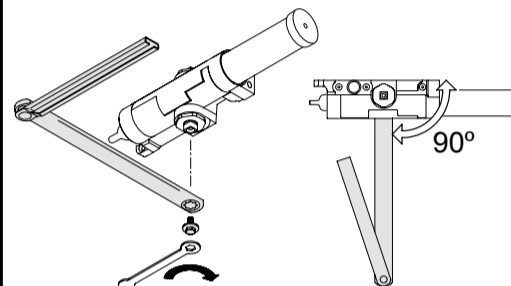

3 FIT MAIN ARM ASSEMBLY TO MECHANISM (90°) SECURELY TIGHTEN FIXING SCREW WITH SPANNER **3**

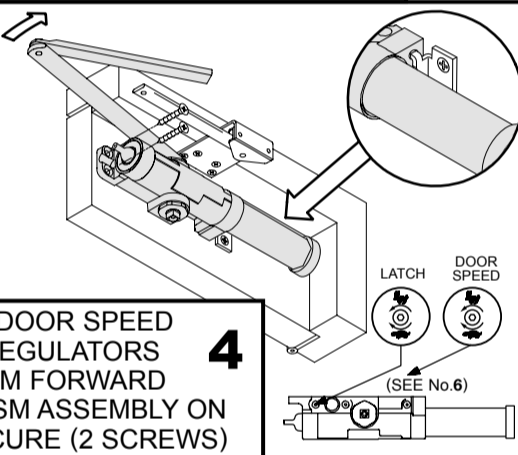
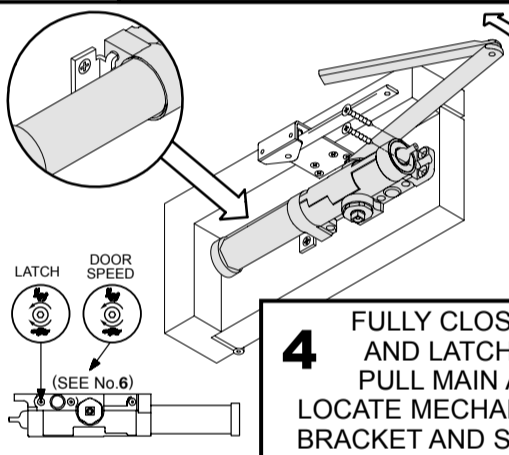

4 FULLY CLOSE DOOR SPEED AND LATCH REGULATORS PULL MAIN ARM FORWARD LOCATE MECHANISM ASSEMBLY ON BRACKET AND SECURE (2 SCREWS)

4 LOCATE MECHANISM ASSEMBLY ON BRACKET AND SECURE (2 SCREWS) **4**

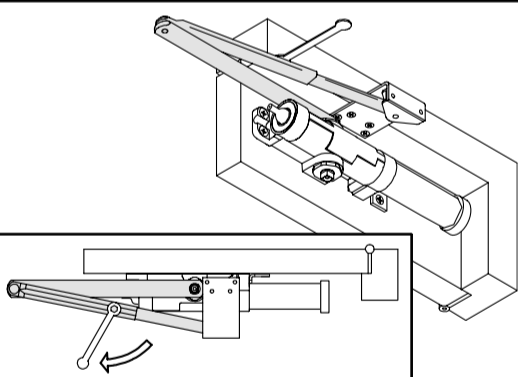
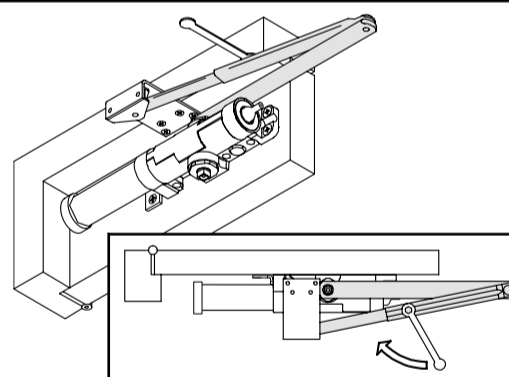

5 OPEN DOOR TO ENGAGE SECONDARY ARM STRIP AND TUBE CLOSE DOOR AND SET MAIN ARM PARALLEL TO DOOR FACE SECURELY TIGHTEN CLAMP BOLT WITH SPANNER **5**

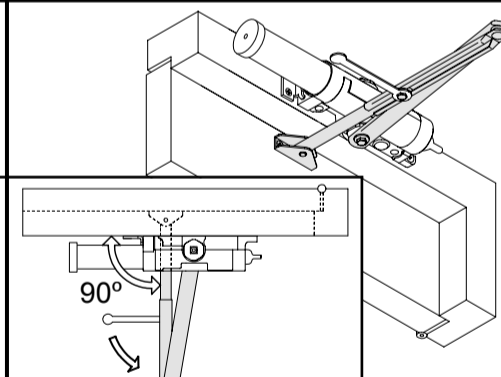
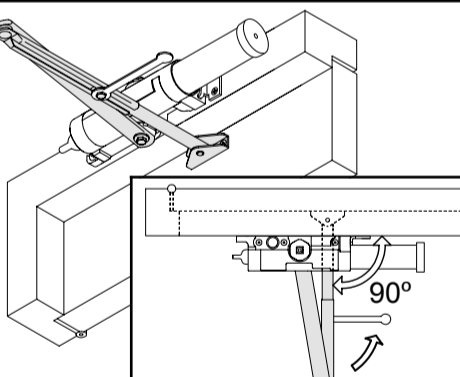

5 OPEN DOOR TO ENGAGE SECONDARY ARM STRIP AND TUBE CLOSE DOOR AND SET SECONDARY ARM AT 90° TO DOOR FACE SECURELY TIGHTEN CLAMP BOLT WITH SPANNER **5**

POWER (FIG.66)

FACTORY SET TO SIZE 3	
CLOSER POWER SIZE	NUMBER OF TURNS (APPROX)
1	-6
2	-4
3	0
4	+4
5	+10

BACKCHECK CLOSER

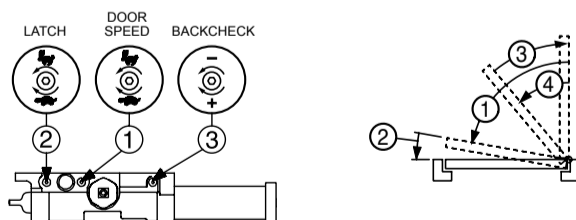

BACKCHECK & DELAYED ACTION CLOSER

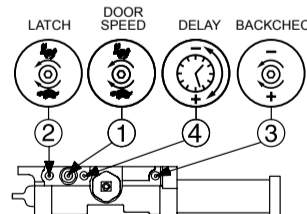

POWER (FIG.61)

FACTORY SET TO SIZE 3	
CLOSER POWER SIZE	NUMBER OF TURNS (APPROX)
2	-3
3	0
4	+3
5	+8
6	+12

6 IF NECESSARY ADJUST POWER AND DOOR SPEEDS **6**

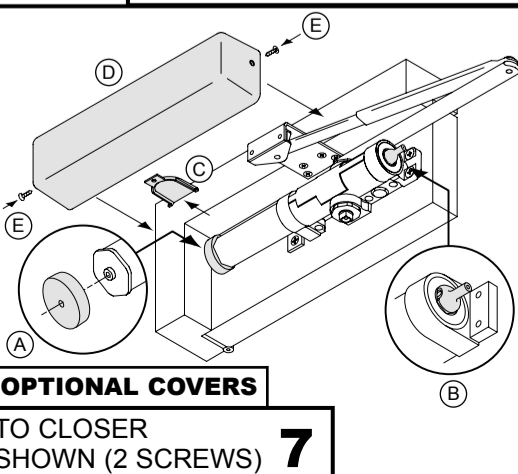
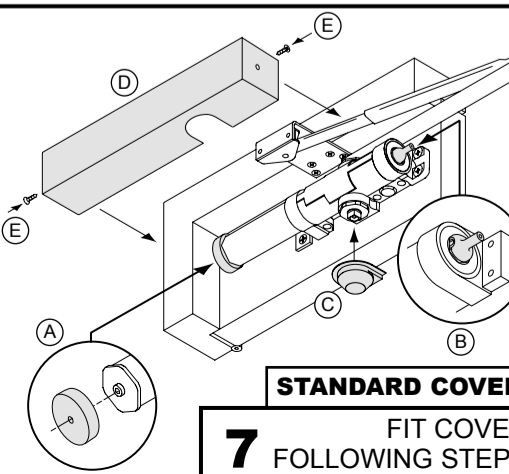

STANDARD COVER **OPTIONAL COVERS**

7 FIT COVER TO CLOSER FOLLOWING STEPS SHOWN (2 SCREWS) **7**

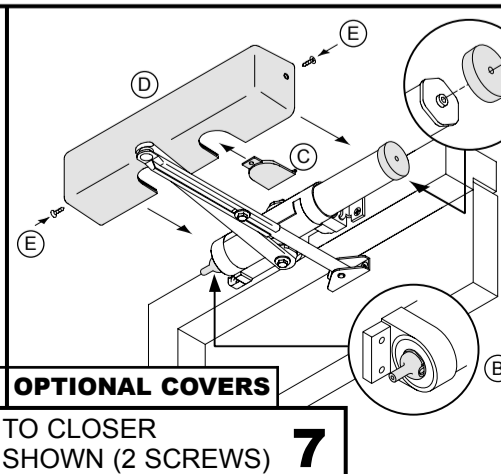
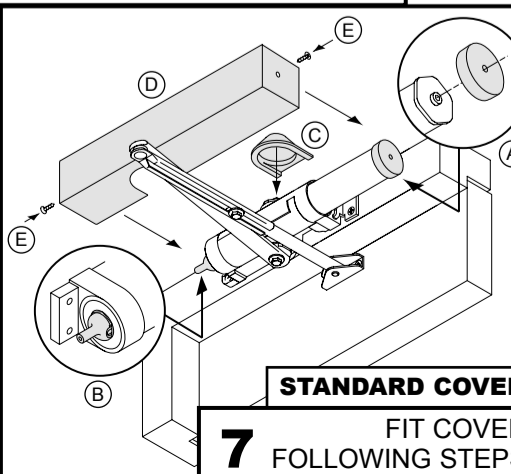

STANDARD COVER **OPTIONAL COVERS**

7 FIT COVER TO CLOSER FOLLOWING STEPS SHOWN (2 SCREWS) **7**