

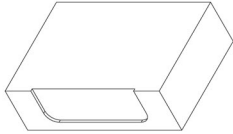

Challenger 3D Butt Hinge Fitting Instructions (Composite/ Timber Doors)



- 1** Route slab with $\varnothing 20$ cutter

- 2** Fit the flag to the slab. Pre-drill holes and secure with screws. The screws should have a countersunk head of 10mm diameter.

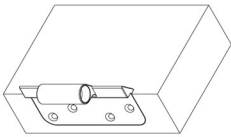

- 3** Lower the slab into the frame, ensure correct placement, clamp if necessary

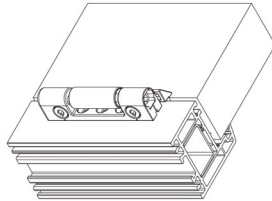

- 4** Clip jig under flag barrel. Drill the two holes for the hinge pins

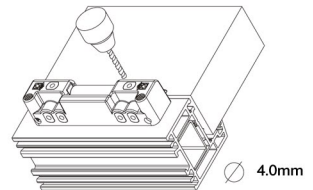

- 6** Lift the slab clear, fit the hinge body and either pre-drill or fix with self drilling screws

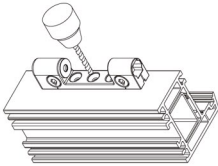

- 6** Fit the two main bushes to the flag barrel (sprung bush to the top).

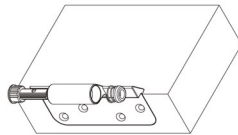

- 7** Lower the slab into the frame allowing the flag barrel to locate into the hinge body. Fit the hinge pin until the head is below the height of the top of the hinge body.

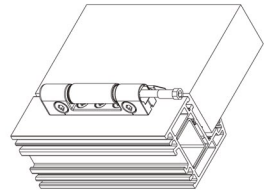

- 8** Lateral and vertical adjustment are pre-set. The hinge pin should be set so that the alignment mark points towards the slab. Other adjustments can be made as necessary.

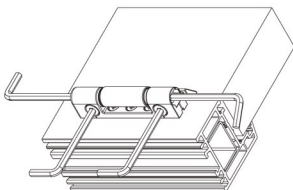

- 9** Fit cover caps if required. The top cap must be fitted as it locks the hinge pin in place,

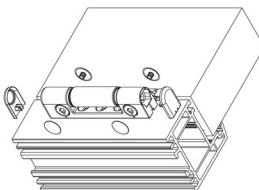

- 10** If required fit the security screw. Do not over-tighten.

