

A = Slide handle
B = Slide handle backplate
C = Outside indicator bolt
D = Keep reciever

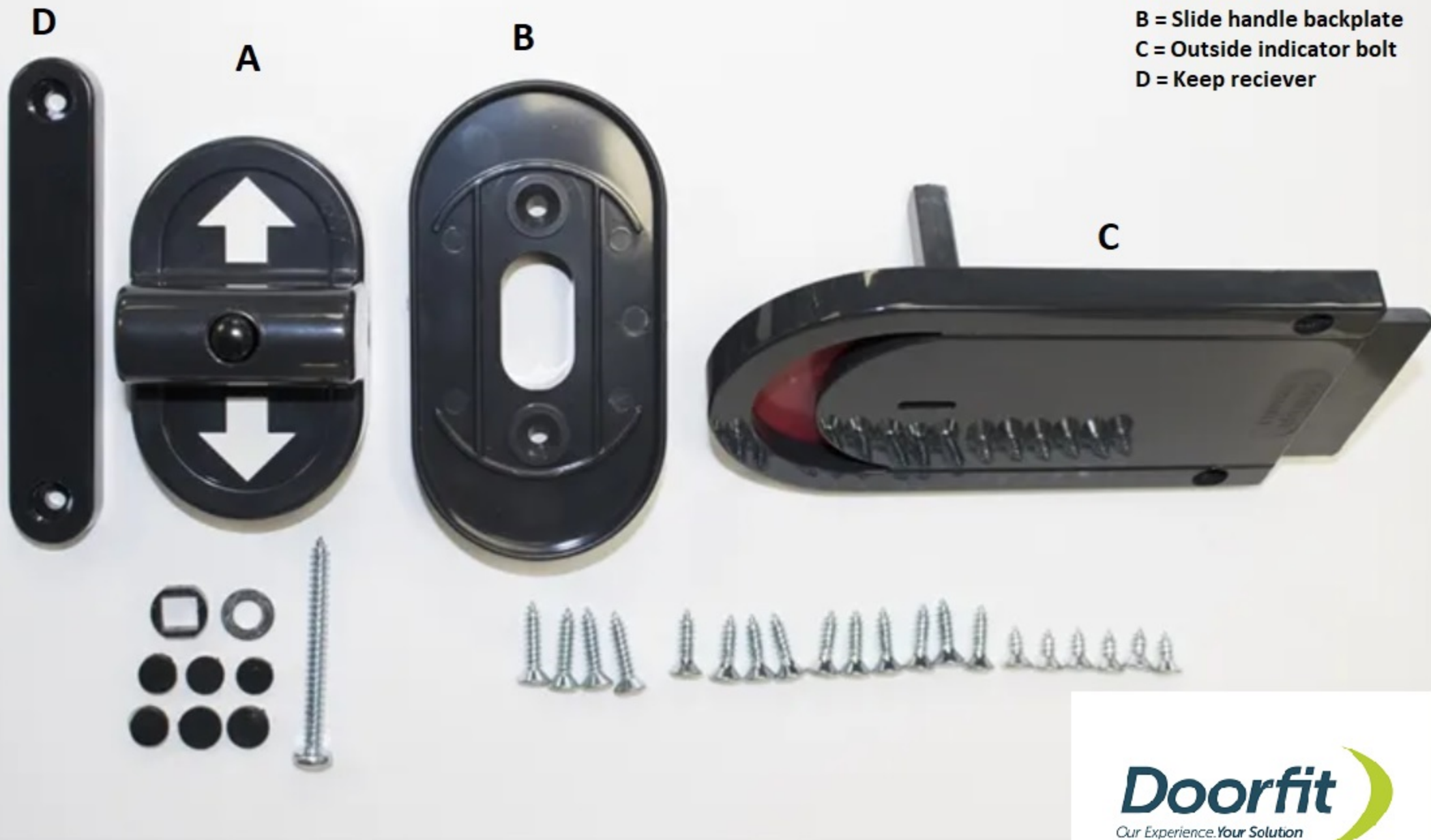

Doorfit
Our Experience. Your Solution

Fitting instructions

1. Fit part C to the outside of your cubicle with the flat edge sitting flush to the edge of the door
2. Fit part B to the inside ensuring the bolt can slide fully left and right
3. Part A then fits onto part B and screws into the metal bar of part C which passes through the door
4. Part D is fitted to the inside of the frame to house the bolt when in a locked position